

S = 1 : 250

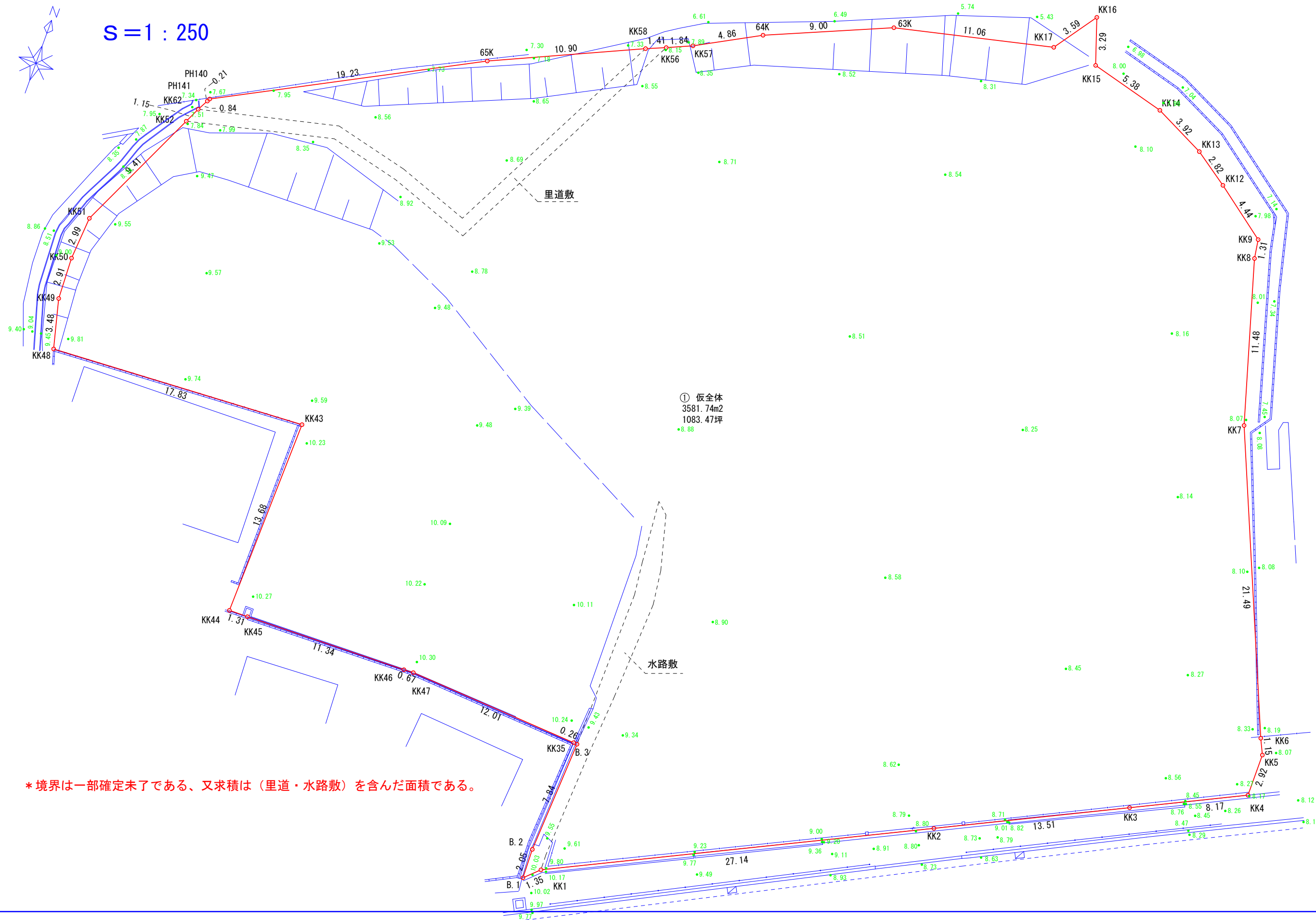
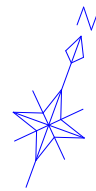

① 仮全体  
3581.74m<sup>2</sup>  
1083.47坪  
8.88

\* 境界は一部確定未了である、又求積は（里道・水路敷）を含んだ面積である。

求積表

地番	① 仮全体			
NO	$X_n$	$Y_n$	$Y_{n+1} - Y_{n-1}$	$X_n \cdot (Y_{n+1} - Y_{n-1})$
B. 1	-183246.336	-71557.867	1.033	-189293.465088
KK1	-183245.402	-71556.892	25.364	-4647836.376328
KK2	-183233.494	-71532.503	36.534	-6694252.469796
KK3	-183227.563	-71520.358	19.493	-3571654.885559
KK4	-183223.975	-71513.010	7.337	-1344314.304575
KK5	-183221.048	-71513.021	-0.510	93442.734480
KK6	-183220.001	-71513.520	-8.920	1634322.408920
KK7	-183200.219	-71521.941	-11.669	2137763.355511
KK8	-183189.202	-71525.189	-3.455	632918.692910
KK9	-183187.899	-71525.396	-3.754	687687.372846
KK12	-183185.227	-71528.943	-5.861	1073648.615447
KK13	-183183.605	-71531.257	-5.831	1068143.600755
KK14	-183181.866	-71534.774	-8.719	1597162.689654
KK15	-183180.481	-71539.976	-6.252	1145244.367212
KK16	-183177.353	-71541.026	-3.124	572246.050772
KK17	-183180.295	-71543.100	-12.855	2354782.692225
63K	-183182.788	-71553.881	-19.052	3489998.476976
64K	-183186.347	-71562.152	-12.544	2297889.536768
KK57	-183188.676	-71566.425	-5.958	1091438.131608
KK56	-183189.421	-71568.110	-2.993	548285.937053
KK58	-183189.971	-71569.418	-11.234	2057956.134214
65K	-183194.490	-71579.344	-26.947	4936541.922030
PH140	-183203.459	-71596.365	-17.128	3137908.845752
PH141	-183203.648	-71596.472	-0.505	92517.842240
KK62	-183204.392	-71596.870	-0.887	162502.295704
KK52	-183205.442	-71597.359	-4.463	817645.887646
KK51	-183213.982	-71601.333	-4.191	767849.798562
KK50	-183216.968	-71601.550	-0.097	17772.045896
KK49	-183219.876	-71601.430	0.978	-179189.038728
KK48	-183223.250	-71600.572	18.666	-3420045.184500
KK43	-183222.298	-71582.764	17.482	-3203092.213636
KK44	-183235.980	-71583.090	0.986	-180670.676280
KK45	-183235.967	-71581.778	12.656	-2319034.398352
KK46	-183235.711	-71570.434	12.019	-2202310.010509
KK47	-183235.682	-71569.759	12.663	-2320313.441166
KK35	-183236.433	-71557.771	12.248	-2244279.831384
B. 3	-183236.449	-71557.511	-0.154	28218.413146
B. 2	-183244.280	-71557.925	-0.356	65234.963680
		合計		-7163.483894
		合計面積		3581.7419470
		地積		3581.74 m <sup>2</sup>

地番	面積
① 仮全体	3581.7419470 m <sup>2</sup>